

SITE PLAN

Scale :-

Schedule Of Openings:

Door - D - 1.05 x 2.14

Window - W - 1.80 x 1.20

Ventilator - V - 0.90 x 0.45

PLA SHOWING EXISTING SRIKANGA COLLEGE OF EDUCATION (B.Ed.) IN SY. NO. 94/7, K.H. No. 186, M. R. No. 120, NEAR RING ROAD, HEMAVATHI NAGAR, LAST STAGE, CHIKKAKONDAGOLA, HASSAN.

Area Statement:

TOTAL AREA - 0 Acre, 28 Ganta

GROUND FLOOR - 28645.00 Sqft.

FIRST FLOOR - 1101.66 Sqft.

SECOND FLOOR - 1101.66 Sqft.

MULTIPURPOSE HALL - 1101.66 Sqft.

TOTAL AREA - 297.39 Sqm OR 3200.0 SF

Applicant Sign: *[Signature]*

Secretary: *[Signature]*

Engineer Sign: *[Signature]*

Approving Authority: *[Signature]*

HPHP Constructions

Suhas H.P., D.C.E.&E.

Consulting Civil Engineer & Contractor

1076, 10th Cross, K.R. Puram, HASSAN. Mob: 9538022093

SURVEY NO: 128, LAKE
45.73

KAMALAMMA'S PROPERTY

89.93

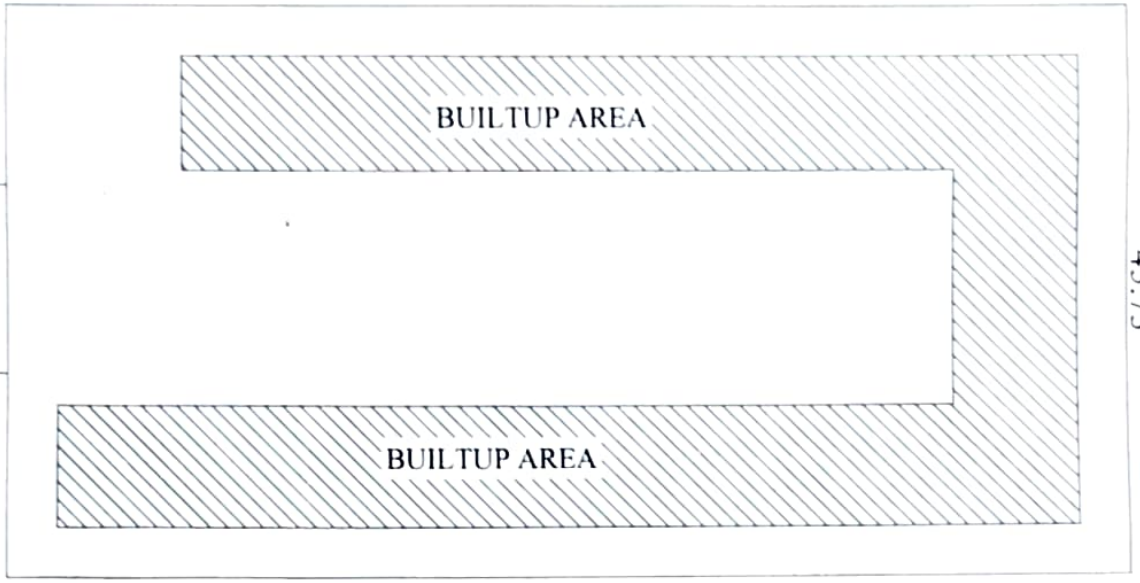

TAMMANNA'S PROPERTY

SITE PLAN

DRAWING SHOWING THE SITE PLAN IN
 SURVEY NO: 94/7, PROPERTY ID: 186, MR NO:
 120, AT NEAR RING ROAD, HEMAWATHI
 NAGAR LAST STAGE, CHIKKAKONNADAGOLA,
 HASSAN (T & D).

AREA STATEMENT

SITE AREA : 13330 SMT.

BUILTUP AREA : 3305 SMT.

SCALE: 1:400

ALL DIMENSIONS ARE IN METER



OWNER:

ANIL KUMAR H S,
 SECRETARY, SRI RANGA B.ED COLLEGE,
 HASSAN.

OWNER SIGNATURE

(Signature)
 For Sri Ranga College of Education

ENGINEER SIGNATURE

(Signature)

Brixwell

Architects & Engineers
 B.M.Road, HASSAN-573201

Reg. Lic.No:HN/R2/10053/19-20

OFFICE USE:



(Signature)
 ಪ್ರಾಧಿಕಾರ
 ಪ್ರಧಾನ ನಿರೀಕ್ಷಕರ
 ಹಾಸನ ಜಿಲ್ಲಾ